

Versatec 500

Water Source/Geothermal Heat Pump

Large Commercial | 7 - 30 Ton



Formerly known as Versatec XL

WaterFurnace
Commercial Solutions

7-10 Ton Horizontal

Also Available in 12 - 15 Ton Horizontal

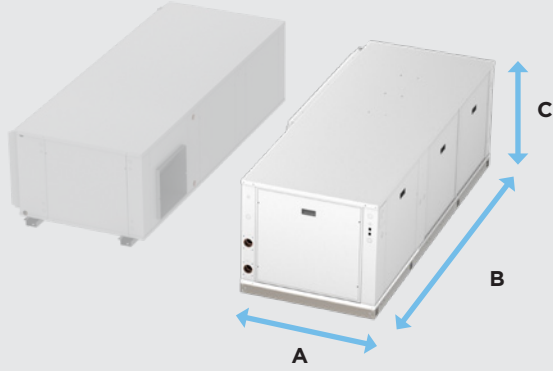

7-10 Ton Vertical

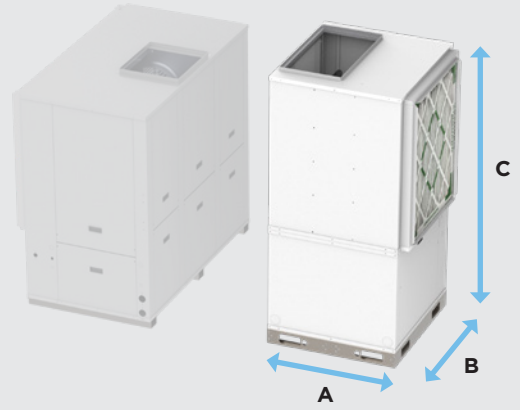

Model	A	B	C
Envision XL (7-10 Ton)	34.5"	89"	24.5"
Versatec 500 (7-10 Ton)	34"	89"	29.9"
Versatec 500 (12-15 Ton)	34"	110"	29.9"

Model	A	B	C
Envision XL	34.1"	61.3"	58"
Versatec 500	34"	36.25"	72.5"

12-15 Ton Vertical

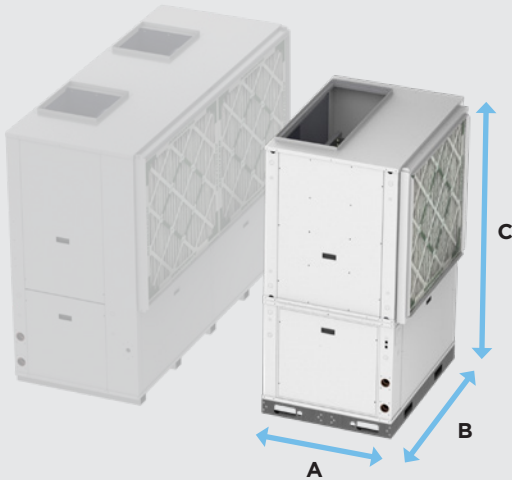

20-30 Ton Vertical

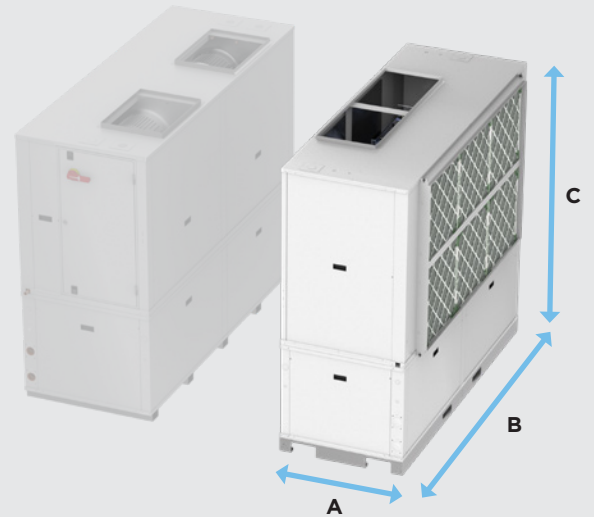

Model	A	B	C
Envision XL	34"	88.1"	66"
Versatec 500	34"	46.3"	72.5"

Model	A	B	C
Envision XL	34"	88.1"	66"
Versatec 500	34"	88"	80"

COMPACT PACKAGE, BIG FEATURES

Now, your customers can get a water source heat pump in sizes up to 30 tons in some of the smallest footprints ever. Versatec 500 is WaterFurnace's latest upgrade to our ever-expanding line of innovative products. We took our current Envision XL product and redesigned it with amazing capabilities and features while occupying a minimal amount of space. No matter what the application calls for—retrofit or new construction—Versatec 500 is an ingenious answer at a cost-effective price point.



Designed to fit through a standard doorway



Easily fits onto a freight elevator

THINKING SMALL SO YOU CAN DREAM BIG

Versatec 500 has dimensions that are among the smallest in the industry. We've reduced the sizes of most of our units—in some cases significantly. For example, lengths on our 7-10 ton vertical shrunk by 41% and our 12-15 ton vertical is 48% smaller lengthwise. That saves six square feet and ten square feet respectively. Imagine what your customers could do with that extra space. Additionally, all of our units fit through a standard door, some via take-apart and others as a complete unit.

BETTER COMPONENTS, BETTER PRODUCT

We didn't just make Versatec 500 compact—we made sure everything inside it was the best solution for what your customers need. Some of our highlight upgrades include:

1 PLENUM FAN

- Backward curve driven design offers greater efficiency and eliminates chance of overloading
- Direct drive instead of a belt drive removes mechanical components that require maintenance
- Significantly reduces mechanical failures due to balance issues
- Provides more uniform airflow across the coil
- Delivers greater static capabilities, producing higher efficiencies and the potential for optimizing filtration
- Capability to control fan speeds over BACnet

2 BRUSHLESS DC ELECTRIC MOTOR

- Variable speed allows operation to adjust according to need
- Operates at quieter performance levels
- Requires less maintenance
- Provides high electrical efficiency

3 AURORA CONTROLS

- Features innovative, industry leading EEV design by using direct drive technology for superior superheat control and eliminating worm gear design.
- Energy monitoring allows users to see real-time and historical usage
- Refrigerant optimization utilizing plug-and-play sensors and EEV provides excellent efficiency while allowing real-time monitoring of superheat and subcooling diagnostics



Inside components



FEATURES THAT MAKE SENSE—AND IMPRESS

First product to offer true interlaced all-aluminum air coils for better performance and longer life. No chances of formicary corrosion.

WATERSIDE ECONOMIZER OPTION

Working independently or in parallel with standard operation, it offers an alternative or additional way to economically cool the space. No need for field installed relays and aqua-stat. Aurora controls econo operation without any special thermostat or BAS commands. Extends life of the compressors. Meets state and local regulations for waterside economizers.

MODULATING REHEAT

Removes humidity for more comfortable conditioned air.

HEAD PRESSURE CONTROL

Improves reheat performance on cold ground loops.

DUAL CAPACITY

7-10 ton units utilize a single 2 stage compressor and 12-30 ton units utilize dual compressors, enabling the system to keep operating if one part needs servicing.

COAXIAL HEAT EXCHANGER

Advanced coax surfaces improve heat transfer and efficiency.

INTELLIZONE2 CAPABILITY

The IntelliZone2 works in unison with our Aurora controls to provide the perfect temperature in up to 4 separate zones.

INTELLIZONE2 COMFORT ZONING

The WaterFurnace IntelliZone2 BACnet™ Comfort Zoning System elevates the ability to maintain comfort and efficiency in commercial applications through seamless integration with your building automation and controls network. Space condition up to six individual zones with Versatec Variable Speed units. This system makes zoning efficient and effective by eliminating the bypass damper, applying a variable speed compressor and ECM blower motor to zoning, and using demand zone calls that allow the controller to better estimate each zone's heating and cooling demands.

Building on the success of the IntelliZone2, the IntelliZone2 BACnet Comfort Zoning System was designed to solve problems inherent to any commercial HVAC zoning system. The system offers flexibility in zone comfort control, system staging, and efficient space conditioning.

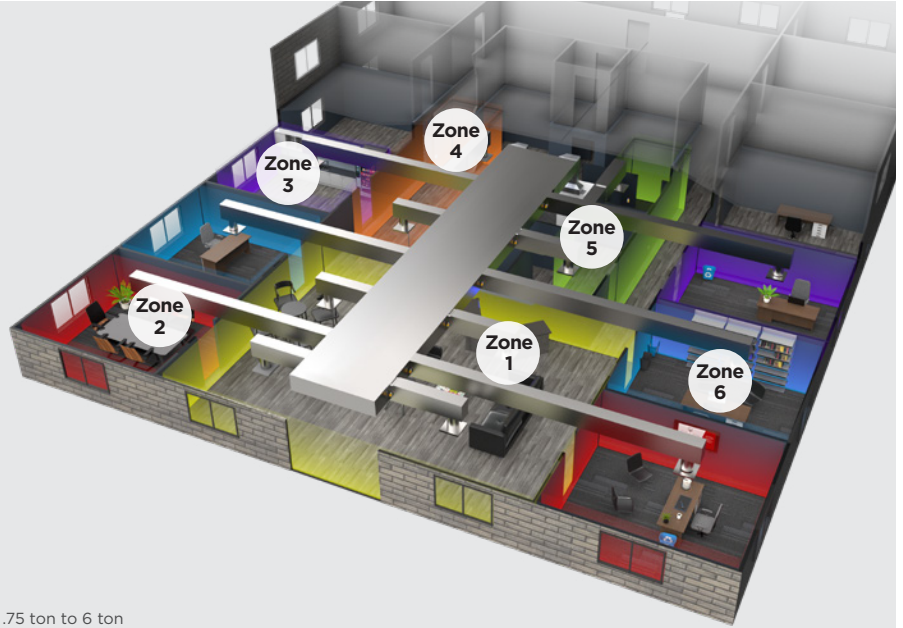

2 Zones	Envision2 Compact single capacity, horizontal and vertical, .75 ton to 6 ton
4 Zones	Envision2 Compact dual capacity, horizontal and vertical, 2 ton to 6 ton Versatec 500, horizontal and vertical, 7 ton to 10 ton
6 Zones	Versatec Variable Speed, horizontal and vertical, 2 ton to 15 ton

*Additional zoning options are available above 15 ton. Please consult the factory for details.
Standard IntelliZone2 Commercial without BACnet is available.*



IntelliZone2 Commercial



IntelliZone2 Commercial BACnet

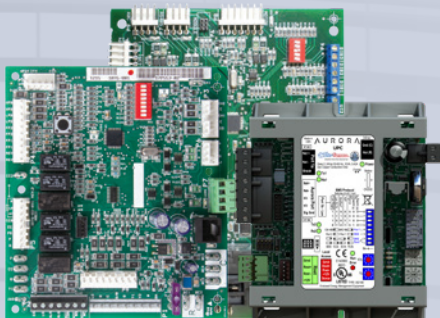

AURORA PREMIUM CONTROLS

Precise monitoring of the full system gives real-time information of the unit's energy usage, performance and more. Refrigerant optimization using plug-and-play sensors and a standard TXV provide excellent efficiency and diagnostics capabilities. When Aurora Premium controls are added, EEV is standard.



ASK US HOW YOU CAN SAVE UP TO 50% ON YOUR NEXT COMMERCIAL PROJECT

With the Inflation Reduction Act, projects completed with a geothermal loop and heat pumps may qualify for:

- 30% bonus rate
- 10% bonus rate for domestic content
- 10% Energy Community bonus
- Up to \$5 per square foot tax deduction
- 5-year accelerate depreciation and a 1-year bonus depreciation



SCAN TO
LEARN MORE



BR2770AU 04/23



visit us at [waterfurnace.com](https://www.waterfurnace.com)